

Saba 50 "Martintin"

Specifics

Model Saba 50
Year of Production 2015

Cabins / max no of berths 6/12
Berths in saloon 0
Bathrooms 6

Length overall (LOA) m 14,98
Beam m 7,99
Draught m 1,25
Displacement kg 15.700

Engine: 2 x Volvo Penta D2 75/41 (Hp/kW)

Fuel tank 940 L
Drive type Saildrive

Winches

1 x electric 6

Deck

Teak on cockpit floor NO
Spray hood YES
Bimini Top (Hardtop) YES
Rail openings both sides YES
Spring cleats YES

Sails

Classic main sail w lazy bag 83,50 m2
Roll genoa 57,50 m2
Gennaker Optional
Mast, height from waterline m 22,44

Instruments

Autopilot (GARMIN GHC 20 Sailpilot) YES
GPS (GARMIN GPSMap 8008) YES
Wind instrument (GARMIN GMI 20) YES
Tridata (GARMIN GMI 20) YES
Mag. Compass YES

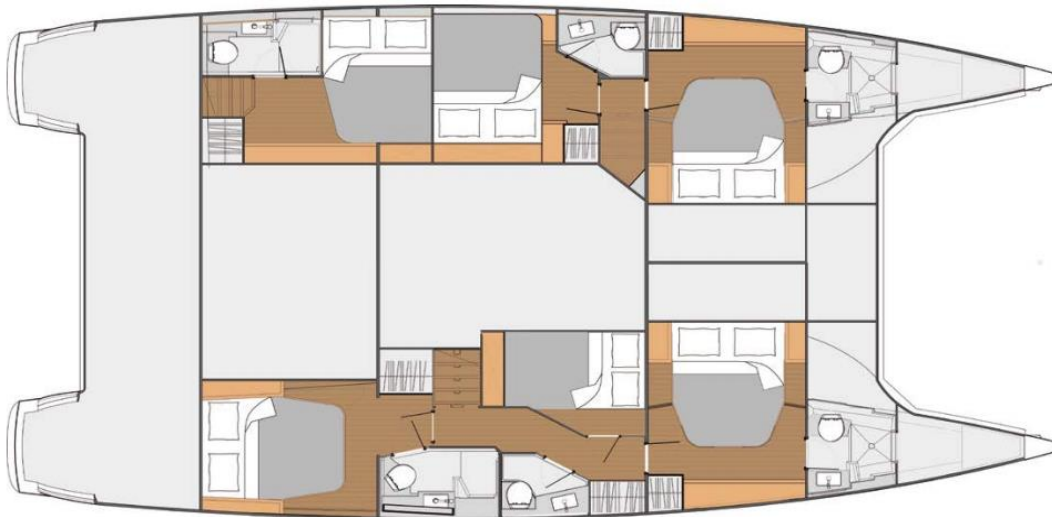

Saba 50 "Martintin"

Steering	x 1
Bow thruster	NO
VHF (GARMIN 300) + AIS	YES
DSC station	YES
Radio w. CD, MP3, AUX, iPod docking	YES
Spkrs in saloon & cockpit	YES

Power generator 220 V	YES
Air conditioning	YES
Heating system with AC	YES
Inverter 3000W	YES
Electrical Windlass	YES
Delta anchor & 80m of chain	YES
Dinghy w outboard	YES

Cockpit

Bathing platform & ladder	YES
Aft shower (H&C water)	YES
Table	YES
Kitchen utensils for	12

Galley

Refrigerator	YES
Freezer	YES

Fresh water system

Fresh water tanks & capacity l	700 L
Water heater	YES

Electrical system

Shore supply	12/220 V
Battery charger	YES
12 V sockets	YES
220 V sockets	YES

Waste water system

Holding tank	YES
Electric toilets	NO

Batteries:

Service	3 x 140 Ah
Engine	4 x 150 Ah

